



MP 52

High Capacity Single Point Load Cell



50kg... 500kg, Type N/C3/C3MR

- Aluminium alloy construction
- Compatible with other sources
- Single point 600 x 600mm platform
- Approved according to OIML R60
- Ex-Version available (MP52/...E)

Applications

- Bench scales
- Counting scales
- Checkweigher

| Technical Data | | N | C3 | C3MR | |
|--|-------------|------------|------------|------------|-------------|
| Accuracy class | | 0.03 | 0.02 | 0.02 | % E_{max} |
| Maximum capacity | E_{max} | s. table | s. table | s. table | |
| Max. usable load | E_u | 150 | 150 | 150 | % E_{max} |
| Destructive load | E_d | > 300 | > 300 | > 300 | % E_{max} |
| Minimum LC verification interval $v_{min} = E_{max}/Y$ | Y | - | 6,000 | 10,000 | |
| Rated output | C_n | 2 | 2 | 2 | mV/V |
| Tolerance on rated output | d_c | ≤ 10 | ≤ 10 | ≤ 10 | % C_n |
| Zero output signal | S_{min} | ≤ 10 | ≤ 10 | ≤ 10 | % C_n |
| Creep, during 30min. | d_{cr} | ≤ 0.025 | ≤ 0.0167 | ≤ 0.0167 | % C_n |
| Temperature effect on S_{min} | TK_{Smin} | ≤ 0.06 | ≤ 0.023 | ≤ 0.014 | % $C_n/10K$ |
| Temperature effect on C | TK_c | ≤ 0.014 | ≤ 0.01 | ≤ 0.01 | % $C_n/10K$ |
| Input impedance | R_{LC} | 415 ± 15 | 415 ± 15 | 415 ± 15 | Ω |
| Output impedance | R_o | 350 ± 3 | 350 ± 3 | 350 ± 3 | Ω |
| Insulation impedance | R_{IS} | > 5,000 | > 5,000 | > 5,000 | MΩ |
| Recommended supply voltage | B_u | 10 | 10 | 10 | V |
| Maximum supply voltage | U_{max} | 15 | 15 | 15 | V |
| Nominal ambient temperature range | B_T | -10 to +40 | -10 to +40 | -10 to +40 | ° C |
| Usable ambient temperature range | B_{Tu} | -30 to +70 | -30 to +70 | -30 to +70 | ° C |

| Technical Data | | N | C3 | C3MR | |
|--------------------------|-----------|------------|------------|------------|----|
| Nominal deflection | s_{nom} | ≤ 0.6 | ≤ 0.6 | ≤ 0.6 | mm |
| Cable length | | 3 | 3 | 3 | m |
| Environmental protection | | IP 65 | IP 65 | IP 65 | |

The technical data given here serve only as a product description and must not be interpreted as guaranteed characteristics in the legal sense.

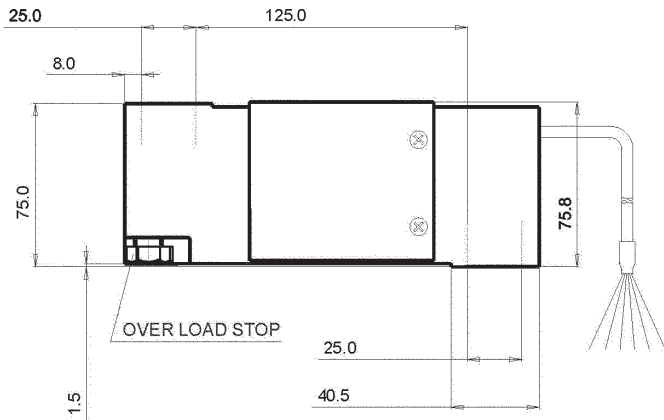

Dimensions in mm

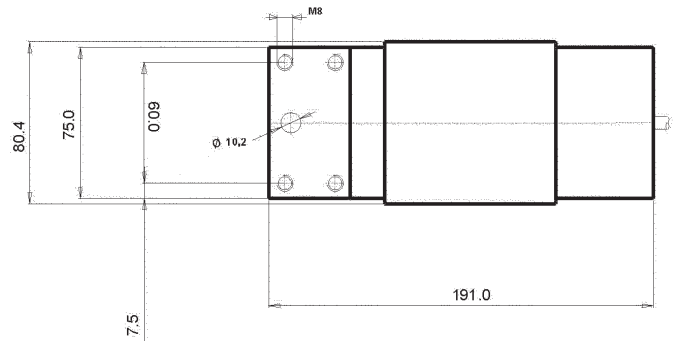

Dimensions in mm

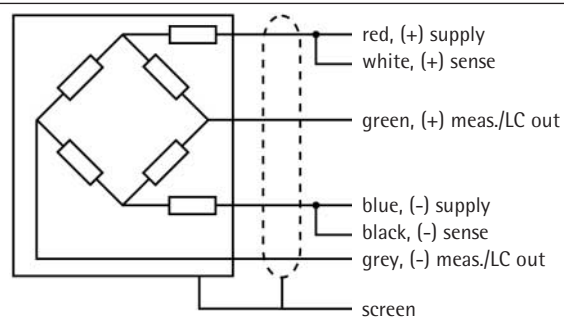

Certificate of conformity

Features: II 1GD T85°C EEx ia IIC T6, II 1GD T115°C EEx ia IIC T4
Reg. Number: SIRA 04 ATEX 2143x

Order number for ATEX load cells

9408 6.. ..
e.g. MP52/100kg C3 E = 9408 652 07110

Order information

| Type | Order number | Type | Order number | Type | Order number | Max. capacity (2mV/V) |
|--------------|----------------|---------------|----------------|-----------------|----------------|-----------------------|
| MP52/50kg N | 9408 252 01050 | MP52/50kg C3 | 9408 252 03050 | MP52/50kg C3MR | 9408 252 07050 | 50kg |
| MP52/75kg N | 9408 252 01075 | MP52/75kg C3 | 9408 252 03075 | MP52/75kg C3MR | 9408 252 07075 | 75kg |
| MP52/100kg N | 9408 252 01110 | MP52/100kg C3 | 9408 252 03110 | MP52/100kg C3MR | 9408 252 07110 | 100kg |
| MP52/150kg N | 9408 252 01115 | MP52/150kg C3 | 9408 252 03115 | MP52/150kg C3MR | 9408 252 07115 | 150kg |
| MP52/200kg N | 9408 252 01120 | MP52/200kg C3 | 9408 252 03120 | MP52/200kg C3MR | 9408 252 07120 | 200kg |
| MP52/250kg N | 9408 252 01125 | MP52/250kg C3 | 9408 252 03125 | MP52/250kg C3MR | 9408 252 07125 | 250kg |
| MP52/300kg N | 9408 252 01130 | MP52/300kg C3 | 9408 252 03130 | MP52/300kg C3MR | 9408 252 07130 | 300kg |
| MP52/500kg N | 9408 252 01150 | MP52/500kg C3 | 9408 252 03150 | MP52/500kg C3MR | 9408 252 07150 | 500kg |